

PowerCube 2.0 / PowerCube mini

Unique Retrofit System Approach

Protection Level: IP54

Warranty: 10 years



On Grid Mode

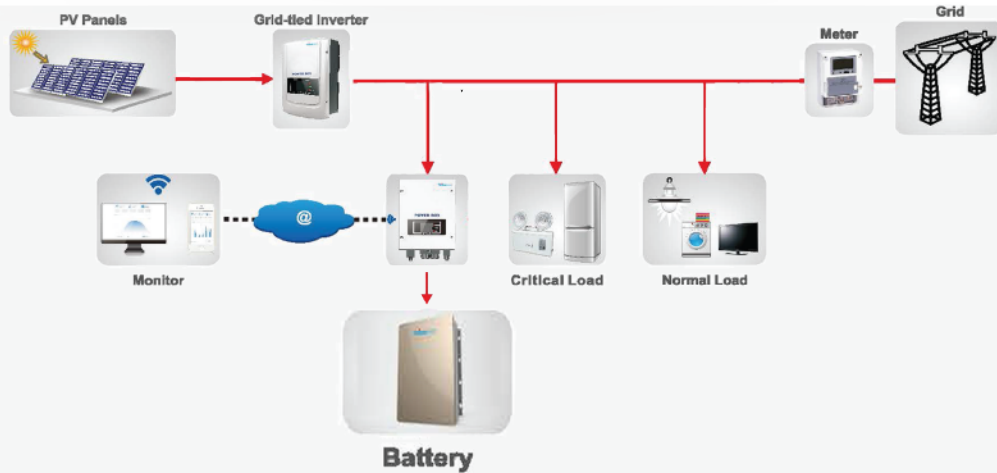

Back Up Mode

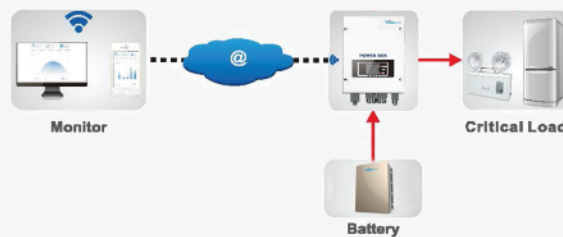

Go net zero

Combine solar to power your home independently.



Solar energy at night



PowerCube stores solar energy and makes it available in the evening.



Emergency backup

Help to use solar energy during utility outage.

Specifications

		PowerCube mini	PowerCube 2.0
 <p>PowerCube mini</p>  <p>PowerCube 2.0</p>	Nominal Voltage	48V	48V
	Nominal Capacity	100Ah	150Ah (3 battery packs) / 200Ah (4 battery packs)
	Energy Capacity	4.8kWh	7.2kWh (3 battery packs) / 9.6kWh (4 battery packs)
	Standard Charging&Discharging Current	50A	75A (3 battery packs) / 100A (4 battery packs)
	Interface	CAN、RS485	CAN、RS485
	Working Temp	-10℃~50℃	-10℃~50℃
	Storage Temp	-25℃~60℃	-25℃~60℃
	Round-trip DC Efficiency	92.5%	92.5%
	Dimension W x H x D	600mm x 530mm x 210mm	600mm x 1000mm x 210mm
	Weight	65kg	app. 95kg (3 battery packs) / 120kg (4 battery packs)
	Protection Level	IP54	IP54
	Warranty	10 years	10 years
 <p>PowerBox</p>	Power rating	3kVA	
	Surge Power Rating	1.5*Pnom,10s;1.2*Pnom,30s	
	Rated output voltage	230V	
	Maximum Output Current	13A	
	Output current range	180-270V	
	Grid Frequency	44-55Hz/54-66Hz	
	THD	<3%	
	Power Factor	1 (selectable +/-0.8)	
	Output type	Single Phase	
	Max Charging efficiency	94.5%	
	Max Discharging Efficiency	94%	
	Standby power	<5W	
	Topology	High Isolation Transformer	
	Protection class	IP65	
	Protections	Anti-islanding, Current leakage detection, ground-fault detection	
	Certifications	AS4777, VDE0126-1-1, G83-2, RD1699, UTEC15-712-1, EN50438, VDE-AR-N4105	
	Communications	WiFi, RS485, CAN2.0	
	Ambient temperature	-25~+60	
	Humidity	0~95%	
	CT connection mode	External	
	Noise levels	<25dB	
	Weight	16kg	
Cooling method	Natural Cooling		
Dimensions	532*360*173mm		
Display	LCD		
Warranty	5 Years (10 years optional)		